

A D.I.Y. Classical Feng Shui Report

# How to Find Your 24 Mountains: Align Yourself With Your Highest Good



TM

By Beth Borray  
Red Peony Feng Shui Consulting  
[www.RedPeony.com](http://www.RedPeony.com)

## Divide your Floorplan into *The 24 Mountains*

In classical Feng Shui practice each of the 8 directions are divided into three 15 degree subdivisions. For example, the South is divided into South 1, South 2, South 3 as are all of the 8 directions. **"The 24 Mountains" are the twenty four 15 degree sectors that make up the 360 degree circle.**

- A. Take the diagram below of your **Red Peony Feng Shui Compass Template** to your local copy shop and have them make a plastic transparency from it.
- B. With a scissor cut around the circle on the red dotted line.
- C. You will overlay this plastic template on your house, office or bedroom floorplan diagram to find the location of your 24 Mountains.

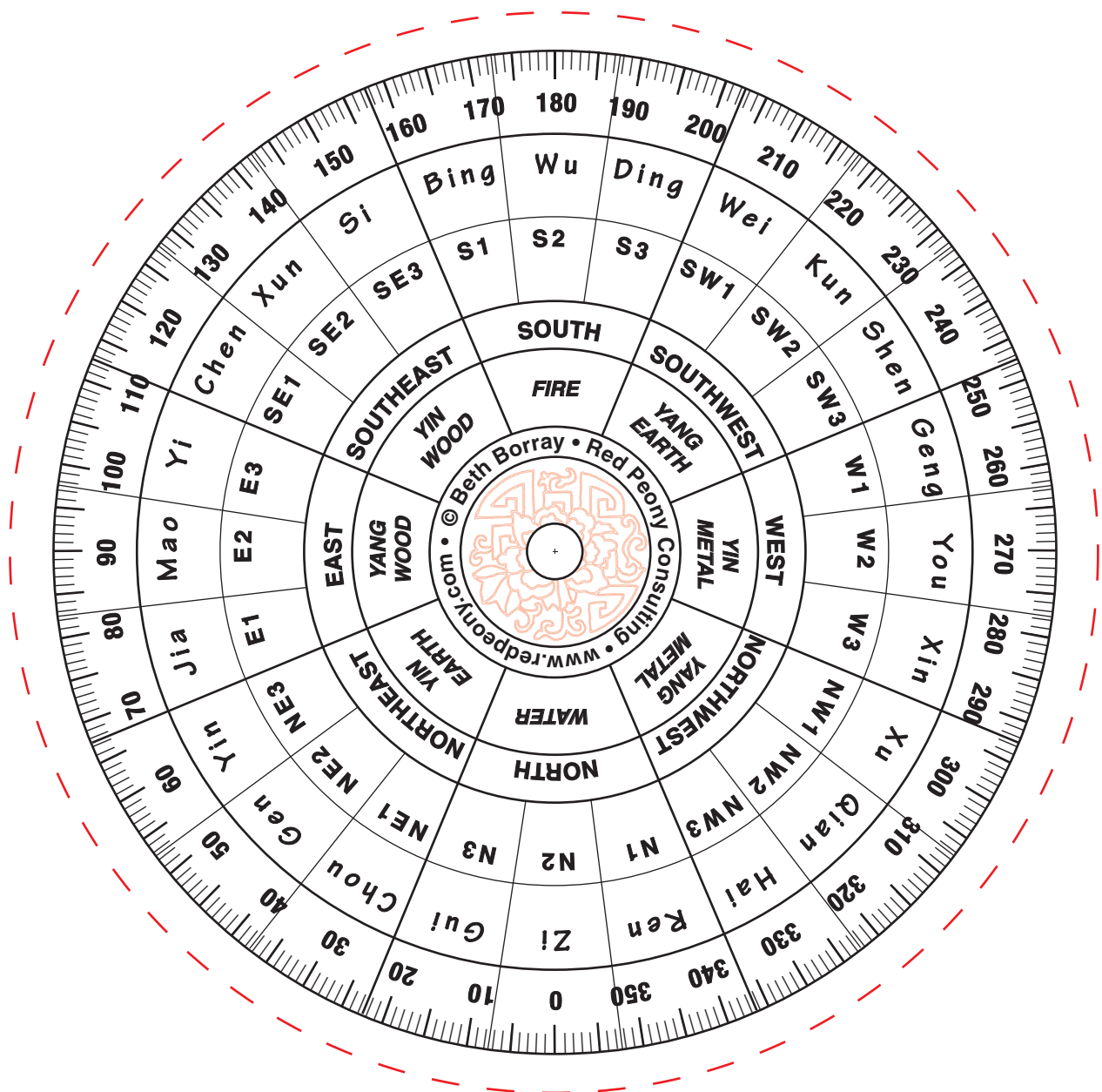

### **Use Your Red Peony Template to Find Your Special Directions:**

- You can use your plastic compass template to draw the directions over your whole house or you can zero in on a single room, like the Master Bedroom or Home Office, and treat it as if it were the whole house.
- If a Special Direction based on your whole house happens to fall in the shower or some other location that won't allow you to activate it properly, you can place it in the secondary location of your bedroom or home office.

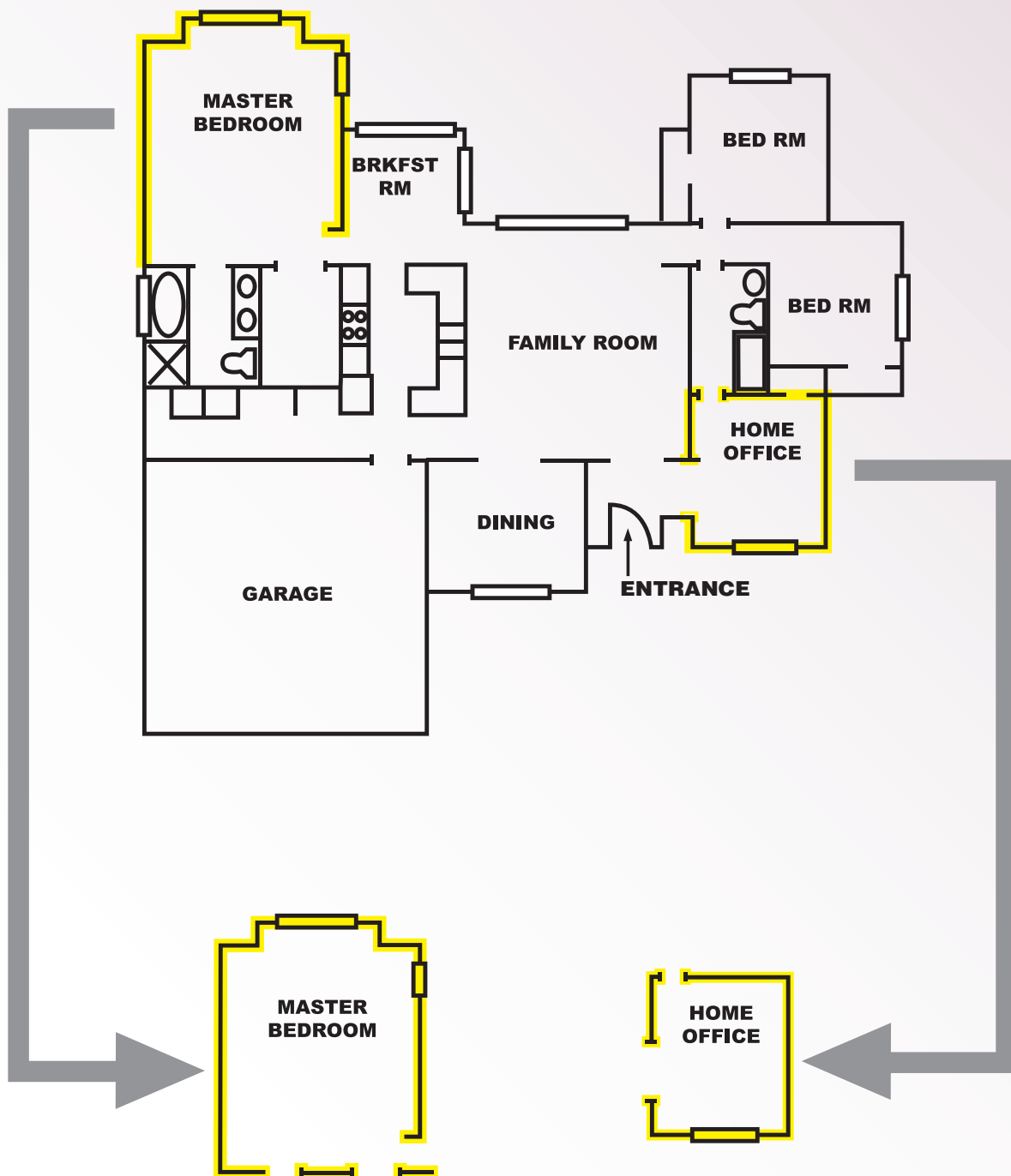

## **A. Find the Magnetic Energy Center**

(see *The Easy Way to Draw Your Floorplan* report if you don't already have one.)

Example:

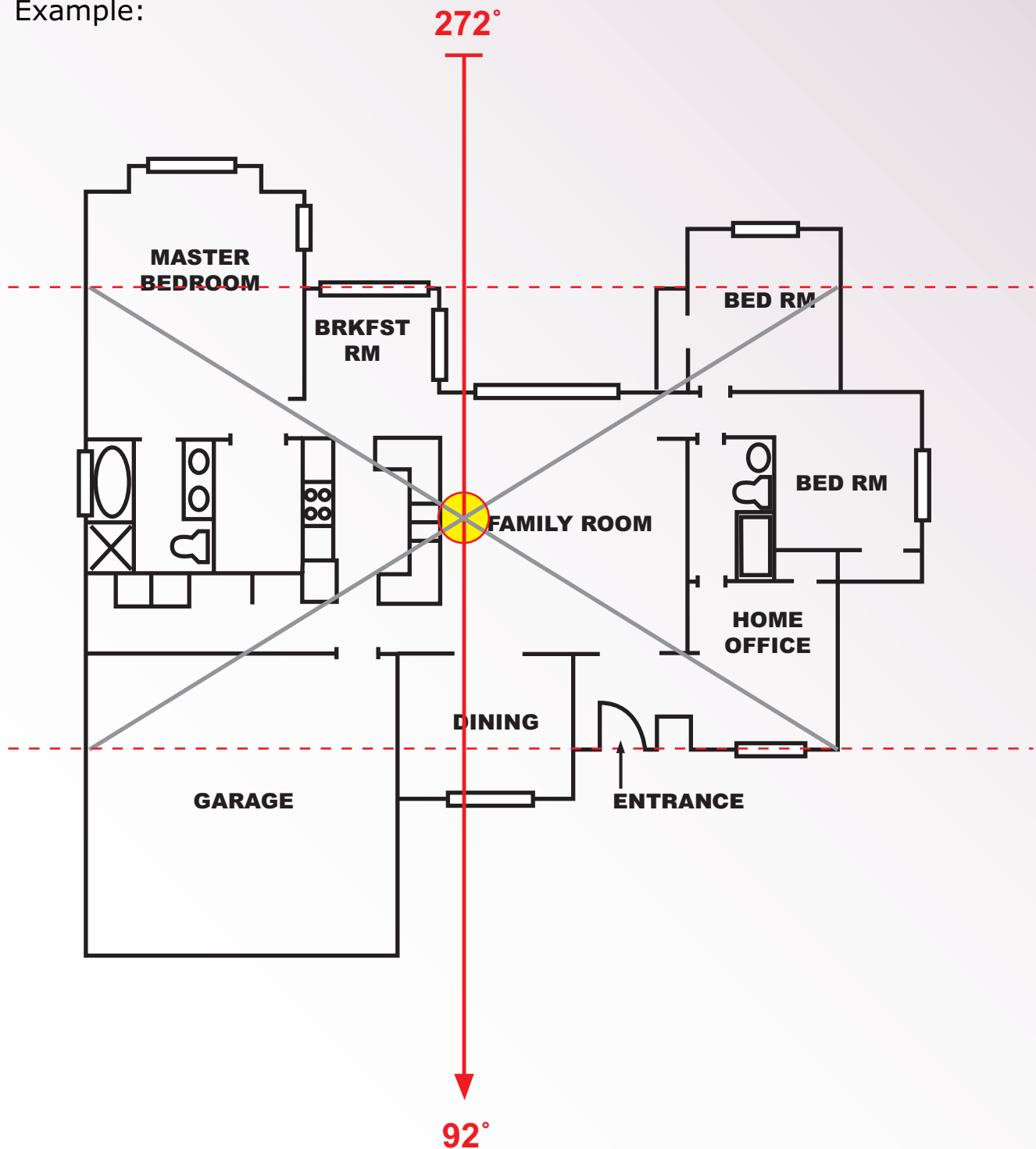



**B. Place your plastic template on top of your floorplan**

- Align it with the Magnetic Energy Center.
- Align it with your Sitting and Facing Compass Degree.

Example: This house is "Sitting" 272 degrees at the back in the West 2 sector, and is "Facing" 92 degrees at the front in the East 2 sector.

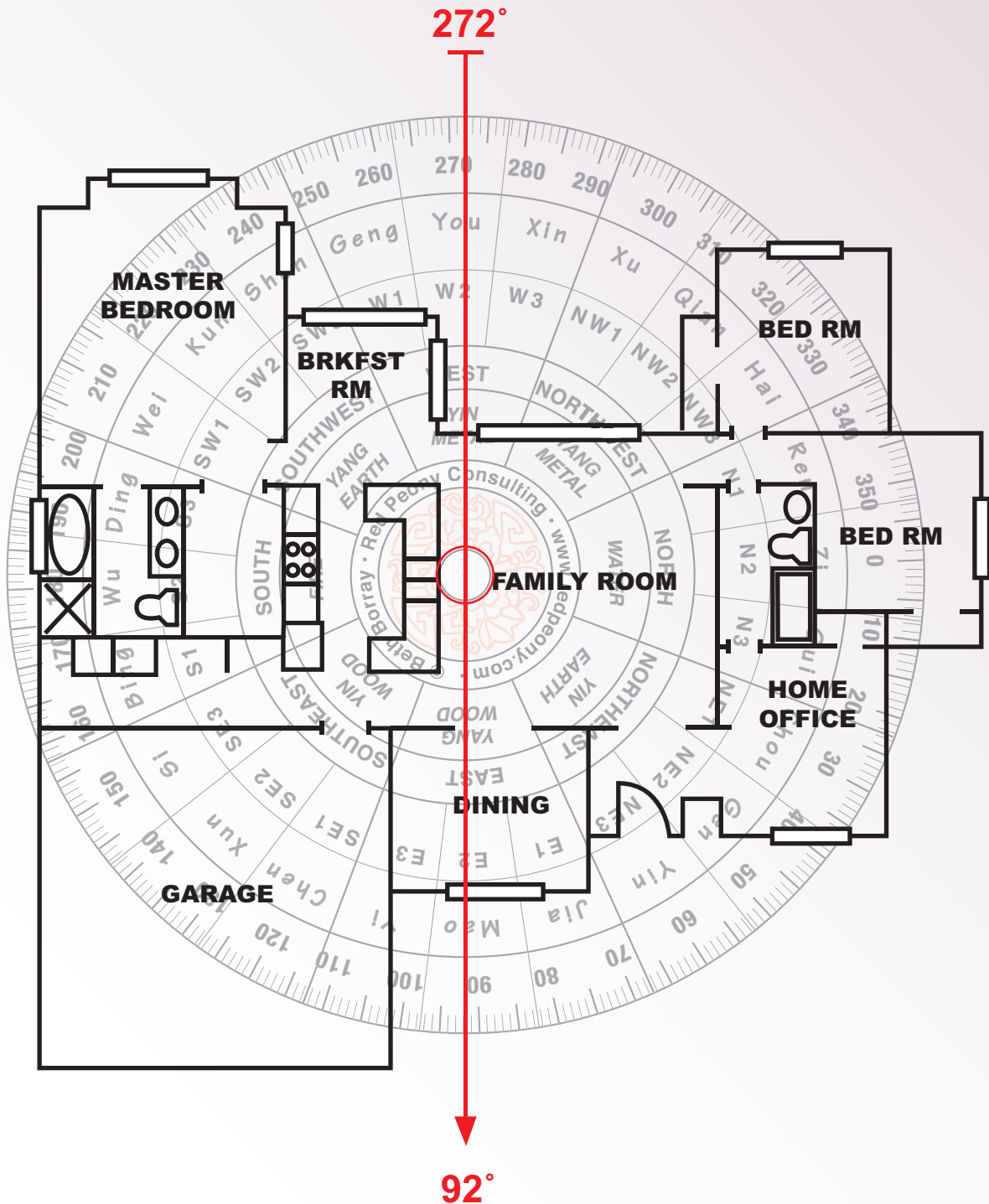

### C. Draw out the Direction lines in pencil

- Tape the plastic compass template down temporarily to keep it steady.
- With a ruler extend the direction lines out from the template.
- Write down the 24 Mountain directions before removing the template.

Example:

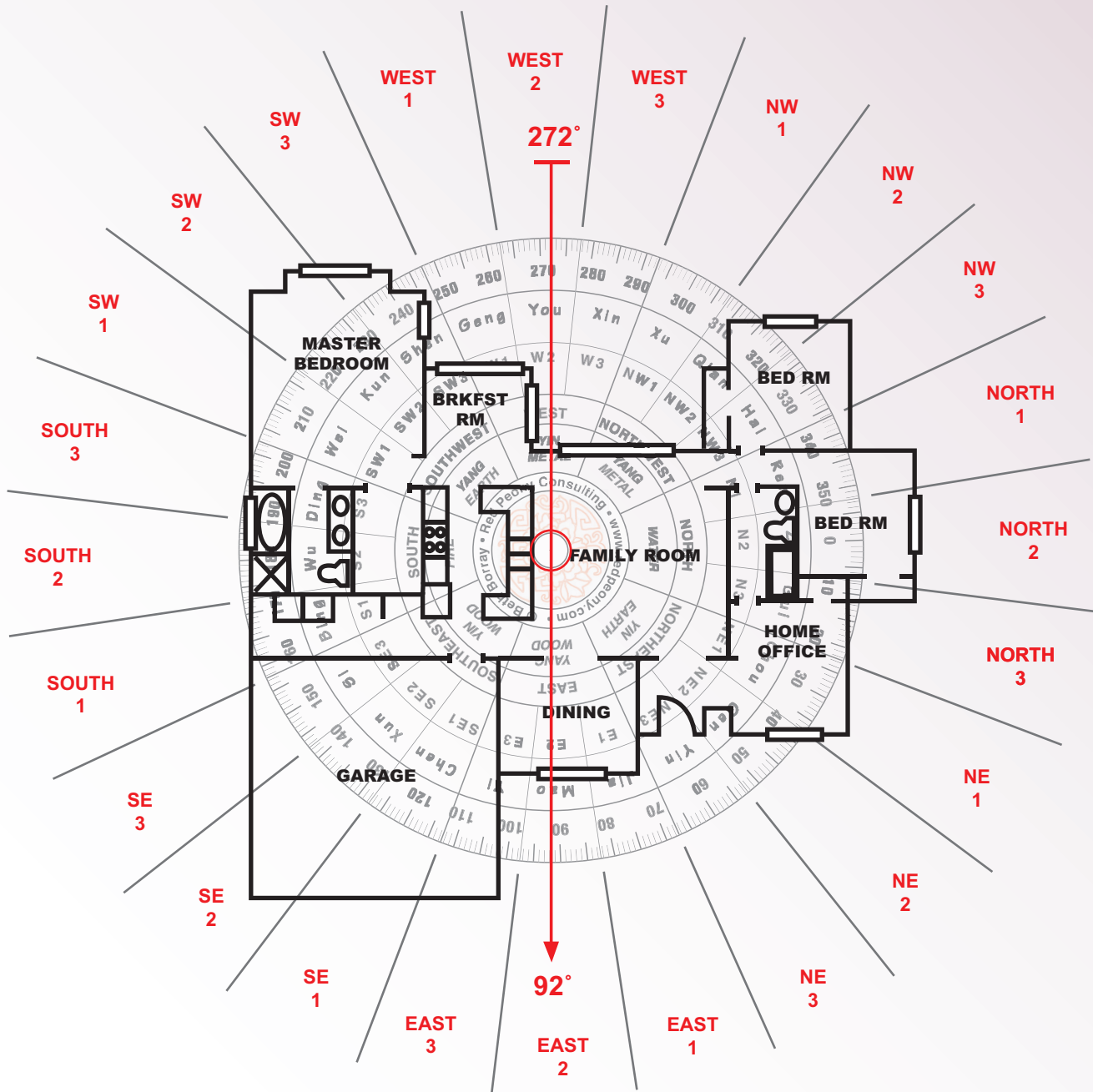

**D. Remove the plastic compass Template.**

- With a ruler connect the direction lines outwards from the magnetic energy center.
- Extend the lines past the house so you can also note the directions in your outside environment.

Example:

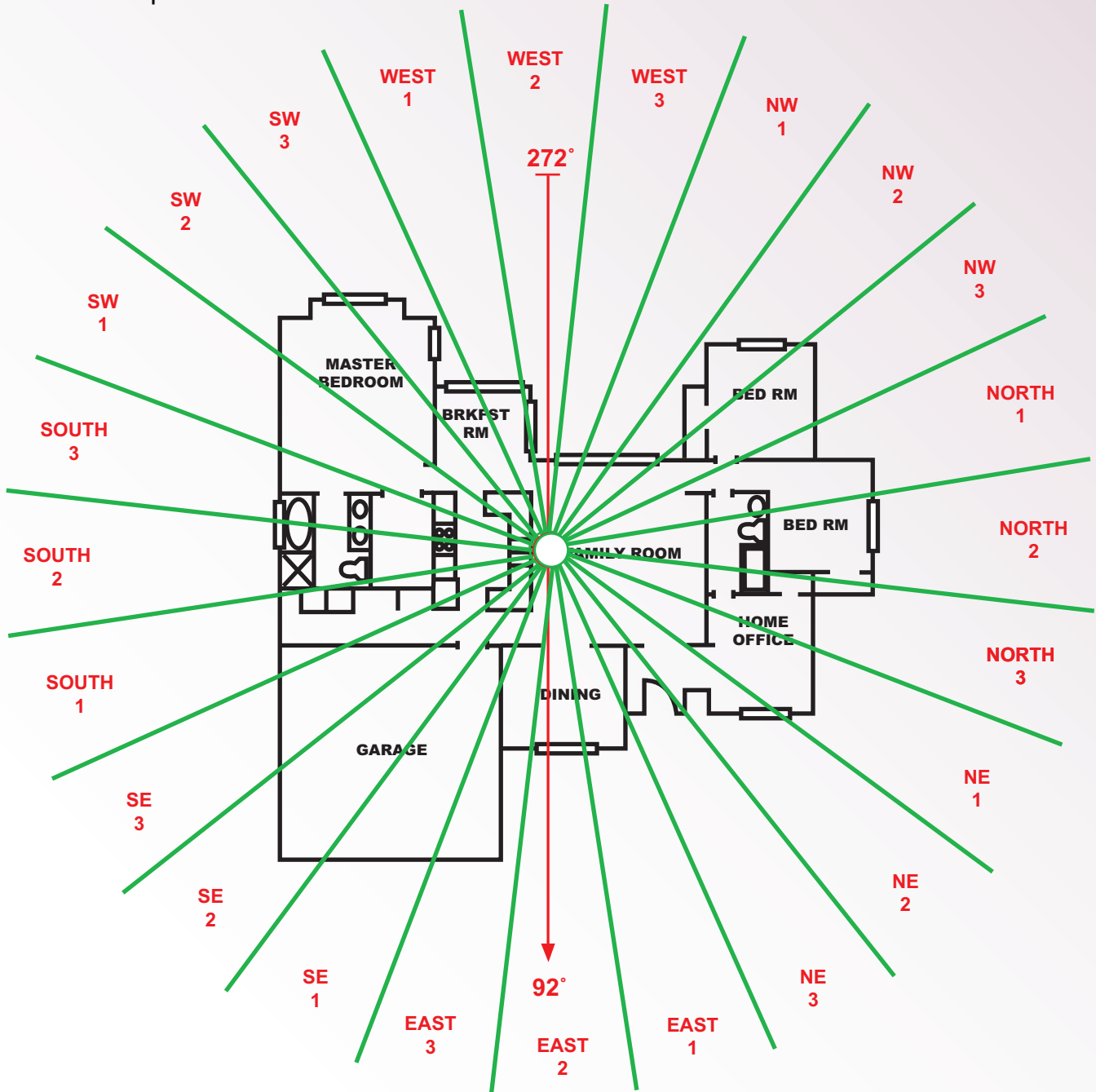

**If you are only working with one room, make sure you keep it aligned with the compass directions of the whole house**

**A. Find the Magnetic Energy Center**

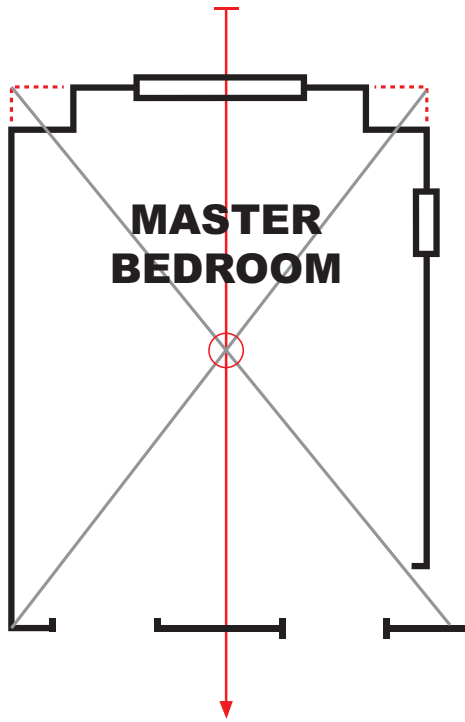

**B. Align your Template with the Magnetic Energy Center and your Sitting and Facing Compass Degree.**

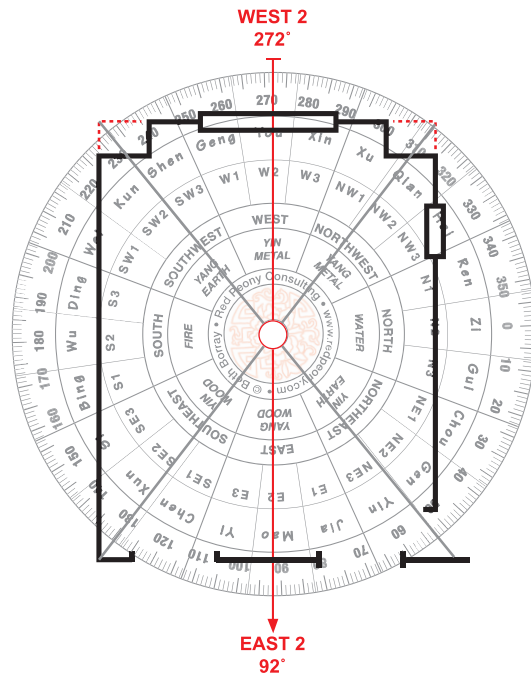

**C. With your Template temporarily taped down, draw out the direction lines in pencil. Then write in the 24 directions.**

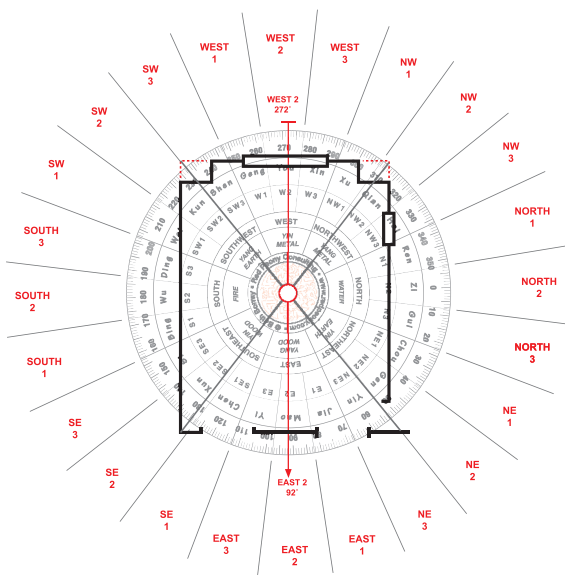

**D. Now remove the template. Connect the direction lines to the magnetic energy center.**

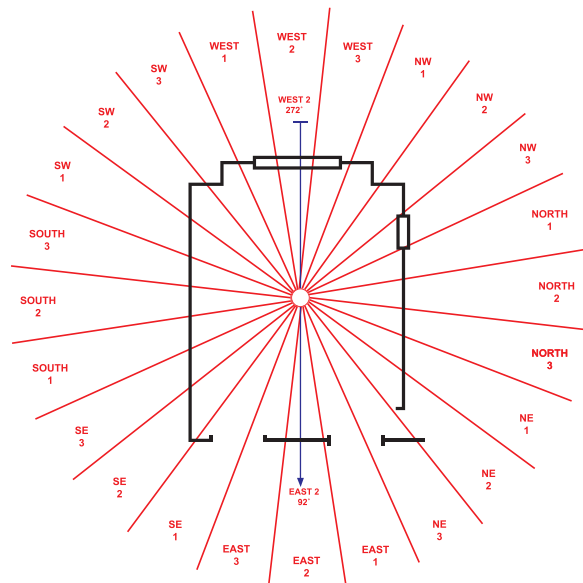



**If you are only working with one room, make sure you keep it aligned with the compass directions of the whole house**

**A. Find the Magnetic Energy Center**

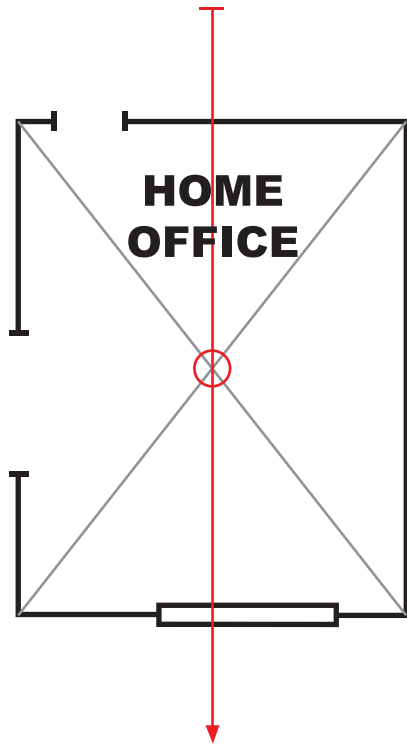

**B. Align your Template with the Magnetic Energy Center and your Sitting and Facing Compass Degree.**

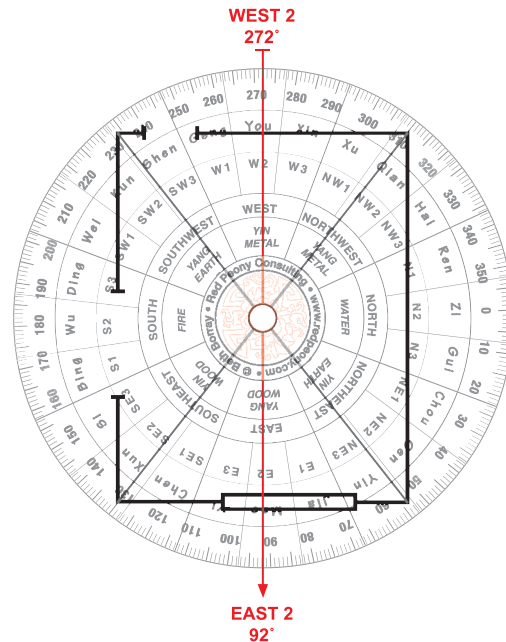

**C. With your Template temporarily taped down, draw out the direction lines in pencil. Then write in the 24 directions.**

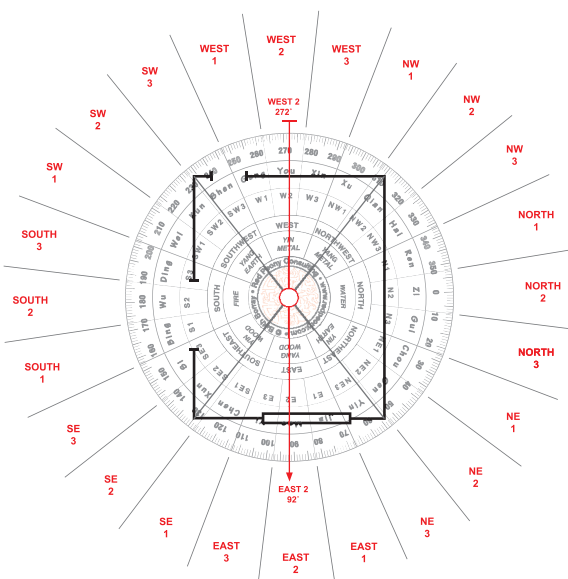

**D. Now remove the template. Connect the direction lines to the magnetic energy center.**

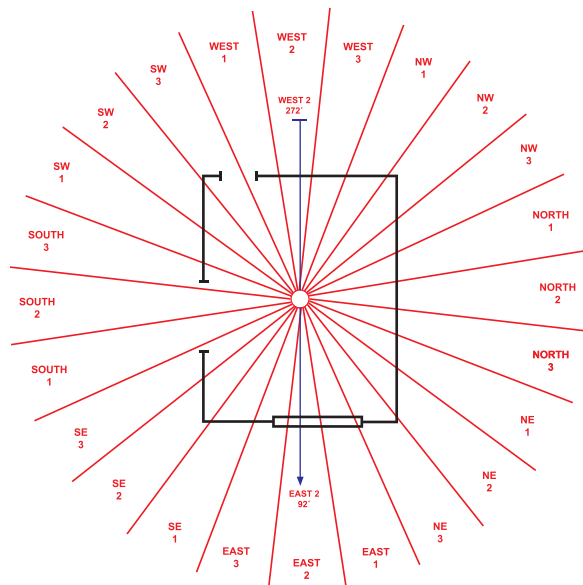

Now that you've worked out precisely where your 24 Mountains are located your Feng Shui attunements can be much more potent.

For Example:

If one of your most favorable directions falls into the Southeast 3 sector of your house you could activate it in the areas marked in yellow below.

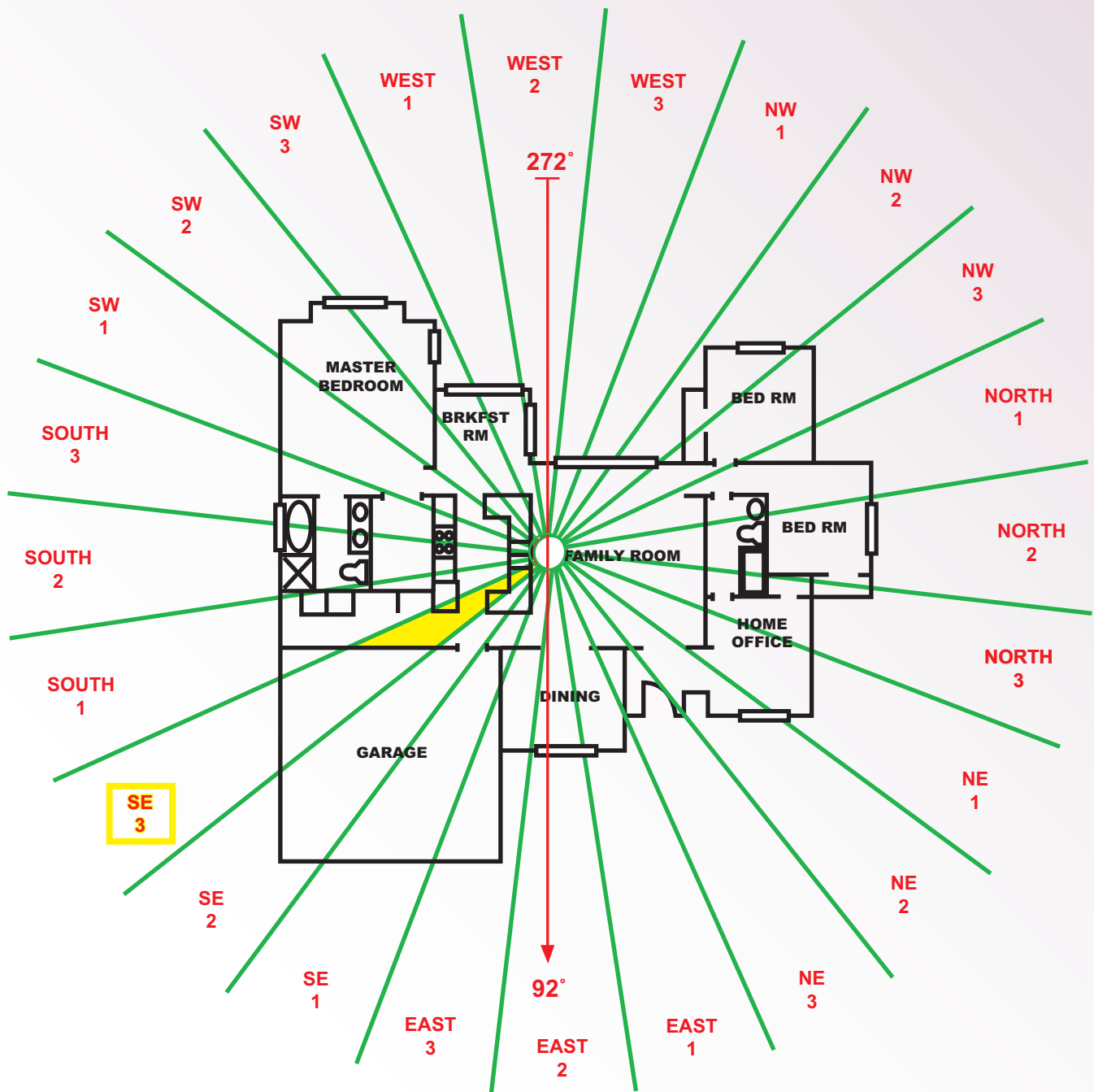

If one of your most favorable directions falls into the Southeast 3 sector of your Bedroom or Home Office for example, you could activate it in the areas marked in yellow below:

**MASTER  
BEDROOM**

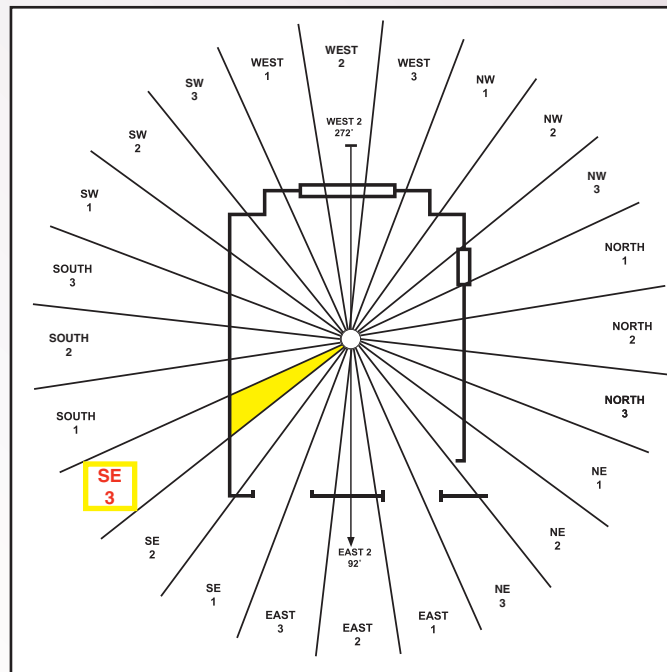

**HOME  
OFFICE**

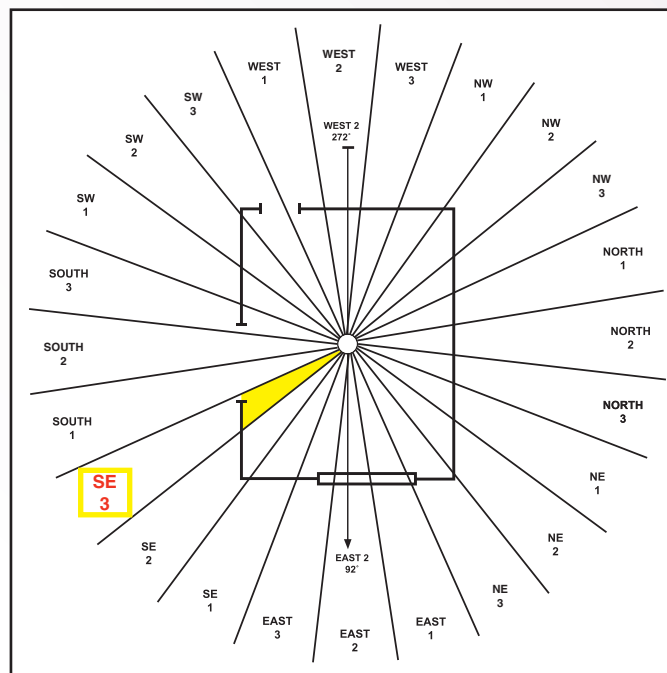

***If you have any questions or would like some personal assistance,  
contact:***

**[Beth@RedPeony.com](mailto:Beth@RedPeony.com)**